

First Floor Plan

1:50

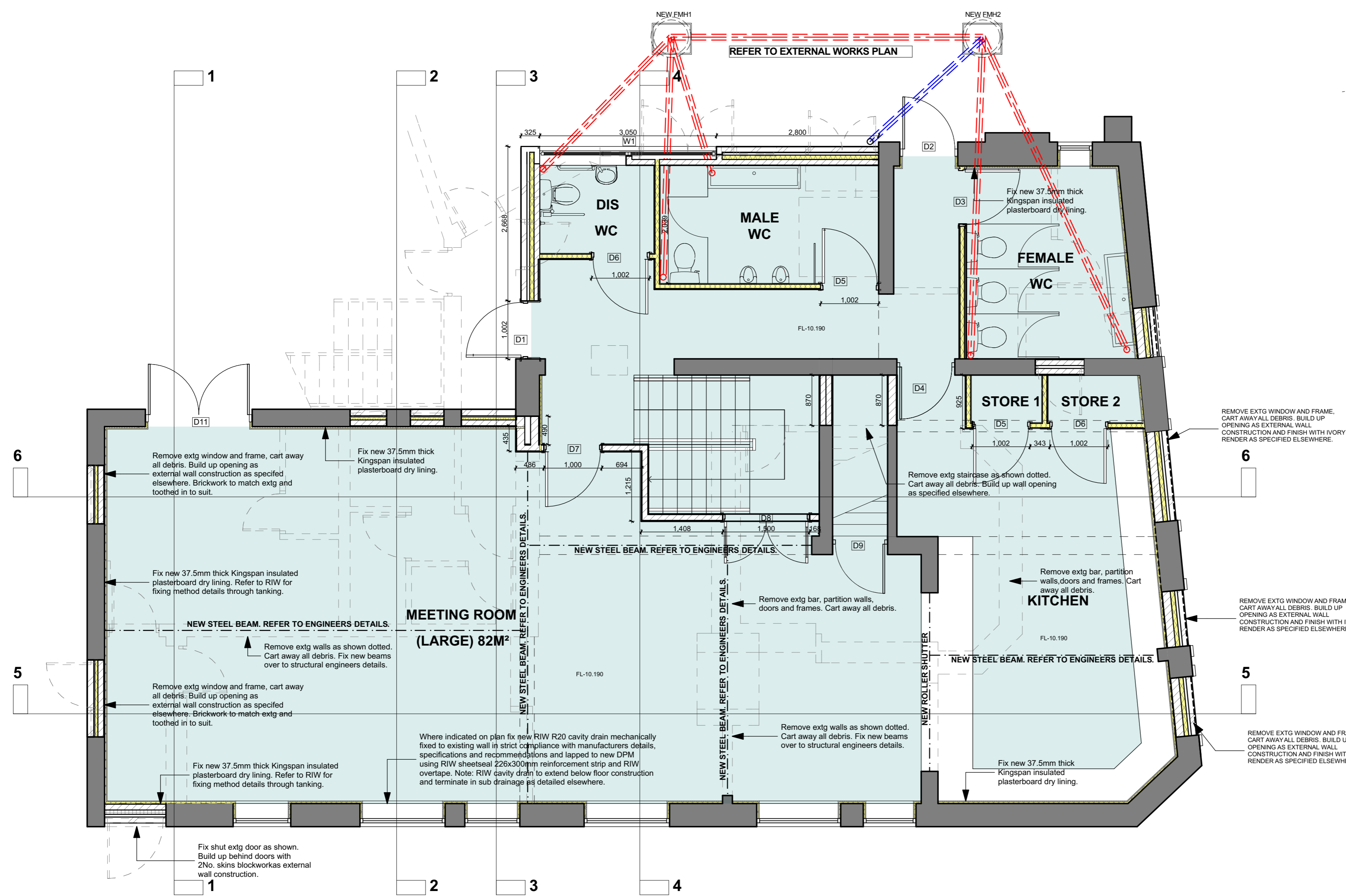

Ground Floor Plan

1:50

wood goldstraw yorath  
 ARCHITECTS QUANTITY SURVEYORS CDM CO-ORDINATORS  
 Churchill House, Regent Road, Stoke on Trent, ST1 3RH.  
 Tel: 01782 208000 Fax: 01782 208112 E-mail: info@woodgoldstraw.co.uk  
 http://www.woodgoldstraw.co.uk/

Client: St. John the Divine CE Church  
 Horninglow, Burton-on-Trent

Project: Conversion of Red Lion Public House

Scale	1:50	Issue Date	08/02/2017
Sheet Size	A2	Drawn	A.Allsopp
Title		Checked	

Working Drawing- Plans

CDM 2015  
 AS MORE THAN 1 CONTRACTOR IS LIKELY TO WORK ON THIS PROJECT THE CLIENT HAS APPOINTED WGY AS PRINCIPAL DESIGNER. THE TENDERING CONTRACTOR IS TO REFER TO THE PRECONSTRUCTION INFORMATION WHEN TENDERING. THE SUCCESSFUL CONTRACTOR WILL BE APPOINTED AS PRINCIPAL CONTRACTOR UNDER CDM 2015 AND IS EXPECTED TO INCLUDE SUFFICIENT MONIES FOR ACTING AS PRINCIPAL CONTRACTOR AND FULFILLING HIS DUTIES UNDER CDM 2015.

Drawing Number	2074-08-11	Revision ID	B
----------------	------------	-------------	---

CAD file path: 3114-CARPENERS-TEAM3-CE-CHURCH-HORNINGLOW-ST-JOHN-THE-DIVINE-CEC02074-08-CONVERSION-OF-RED-LION-PUBLIC-HOUSE-2074-08-WORKING-DRAWING.dwg  
 Copyright: Wood Goldstraw & Yorath.  
 Consents are to check all dimensions on site and refer any discrepancies to the Architects immediately. Do not scale from this drawing.